

Quadrox POS Fusion DVR Integration



Example POS Fusion Screen

The following document will cover the Quadrox POS Fusion DVR Integration.

The pos fusion integration will allow you to view a video of a recalled transaction, on the register (station) from which you recalled it. You can view video of the transactions from any camera on any station you recall the invoice from.

Prior to any Configuration in CRE/RPE

Before configuring CRE/RPE to work with the Quadrox POS Fusion DVR, the Company or service provider for the Quadrox POS Fusion dvr system should setup all configuration for it, in the POS Fusion Folder (located in c:\program files\cre.net\posfusion by default) or where ever it is setup.

For more information on configuring the Quadrox POS Fusion application please contact the company or service provider for the Quadrox POS Fusion DVR.

PosFusion.exe should be in working condition, before setup with CRE or RPE.

External DVR Setup

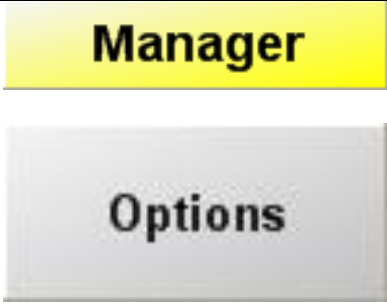
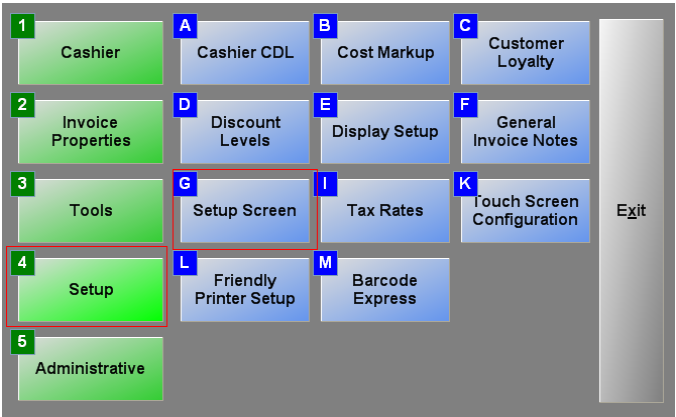
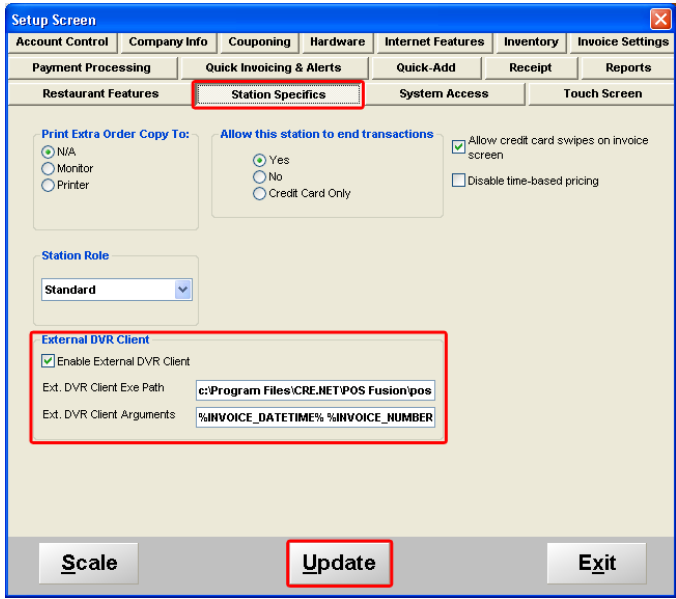
	<ol style="list-style-type: none"> 1. Select Manager/Options and enter your administrator password (default: admin) where applicable.
	<ol style="list-style-type: none"> 2. Select Setup and then Setup Screen.
	<ol style="list-style-type: none"> 3. Select Station Specifics. 4. Under External DVR Client select Enable External DVR Client. 5. For Ext. DVR Client Exe Path enter the directory where the application resides (i.e. C:\Program Files\CRE.NET\POS Fusion). 6. For Ext. DVR Client Exe Path enter the following: %INVOICE_DATETIME% %INVOICE_NUMBER% 7. Select Update.

Recalling an Invoice to Show the Video

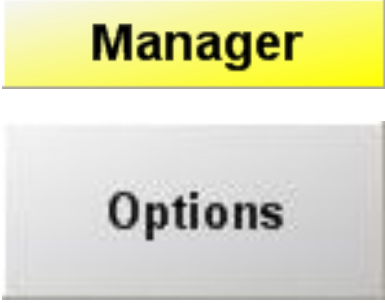
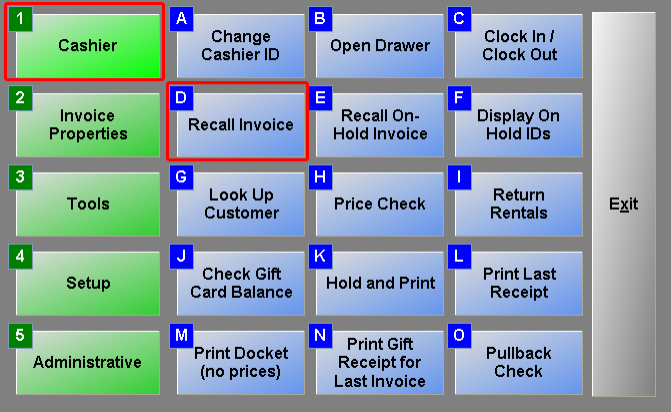
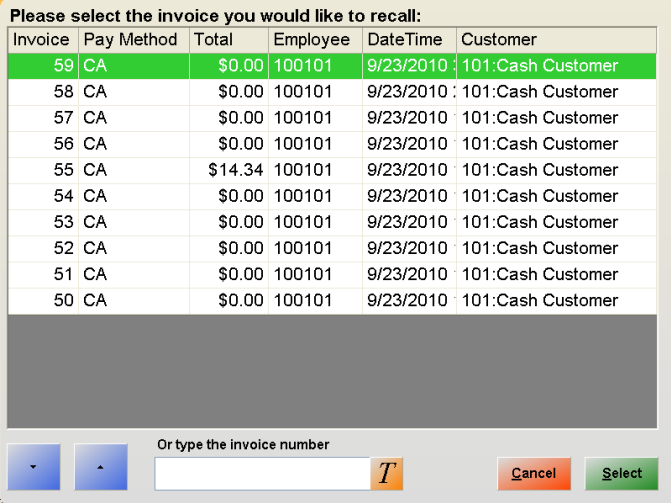
	<ol style="list-style-type: none"> 1. After logging into CRE/RPE select Manager/Options and enter your administrator password (default: admin) where applicable. 																																																																		
	<ol style="list-style-type: none"> 2. Select Cashier and then Recall Invoice. 																																																																		
 <table border="1"> <thead> <tr> <th>Invoice</th> <th>Pay Method</th> <th>Total</th> <th>Employee</th> <th>DateTime</th> <th>Customer</th> </tr> </thead> <tbody> <tr> <td>59</td> <td>CA</td> <td>\$0.00</td> <td>100101</td> <td>9/23/2010</td> <td>101:Cash Customer</td> </tr> <tr> <td>58</td> <td>CA</td> <td>\$0.00</td> <td>100101</td> <td>9/23/2010</td> <td>101:Cash Customer</td> </tr> <tr> <td>57</td> <td>CA</td> <td>\$0.00</td> <td>100101</td> <td>9/23/2010</td> <td>101:Cash Customer</td> </tr> <tr> <td>56</td> <td>CA</td> <td>\$0.00</td> <td>100101</td> <td>9/23/2010</td> <td>101:Cash Customer</td> </tr> <tr> <td>55</td> <td>CA</td> <td>\$14.34</td> <td>100101</td> <td>9/23/2010</td> <td>101:Cash Customer</td> </tr> <tr> <td>54</td> <td>CA</td> <td>\$0.00</td> <td>100101</td> <td>9/23/2010</td> <td>101:Cash Customer</td> </tr> <tr> <td>53</td> <td>CA</td> <td>\$0.00</td> <td>100101</td> <td>9/23/2010</td> <td>101:Cash Customer</td> </tr> <tr> <td>52</td> <td>CA</td> <td>\$0.00</td> <td>100101</td> <td>9/23/2010</td> <td>101:Cash Customer</td> </tr> <tr> <td>51</td> <td>CA</td> <td>\$0.00</td> <td>100101</td> <td>9/23/2010</td> <td>101:Cash Customer</td> </tr> <tr> <td>50</td> <td>CA</td> <td>\$0.00</td> <td>100101</td> <td>9/23/2010</td> <td>101:Cash Customer</td> </tr> </tbody> </table>	Invoice	Pay Method	Total	Employee	DateTime	Customer	59	CA	\$0.00	100101	9/23/2010	101:Cash Customer	58	CA	\$0.00	100101	9/23/2010	101:Cash Customer	57	CA	\$0.00	100101	9/23/2010	101:Cash Customer	56	CA	\$0.00	100101	9/23/2010	101:Cash Customer	55	CA	\$14.34	100101	9/23/2010	101:Cash Customer	54	CA	\$0.00	100101	9/23/2010	101:Cash Customer	53	CA	\$0.00	100101	9/23/2010	101:Cash Customer	52	CA	\$0.00	100101	9/23/2010	101:Cash Customer	51	CA	\$0.00	100101	9/23/2010	101:Cash Customer	50	CA	\$0.00	100101	9/23/2010	101:Cash Customer	<ol style="list-style-type: none"> 3. Highlight the invoice you would like to recall (or enter the invoice number) and select, Select.
Invoice	Pay Method	Total	Employee	DateTime	Customer																																																														
59	CA	\$0.00	100101	9/23/2010	101:Cash Customer																																																														
58	CA	\$0.00	100101	9/23/2010	101:Cash Customer																																																														
57	CA	\$0.00	100101	9/23/2010	101:Cash Customer																																																														
56	CA	\$0.00	100101	9/23/2010	101:Cash Customer																																																														
55	CA	\$14.34	100101	9/23/2010	101:Cash Customer																																																														
54	CA	\$0.00	100101	9/23/2010	101:Cash Customer																																																														
53	CA	\$0.00	100101	9/23/2010	101:Cash Customer																																																														
52	CA	\$0.00	100101	9/23/2010	101:Cash Customer																																																														
51	CA	\$0.00	100101	9/23/2010	101:Cash Customer																																																														
50	CA	\$0.00	100101	9/23/2010	101:Cash Customer																																																														

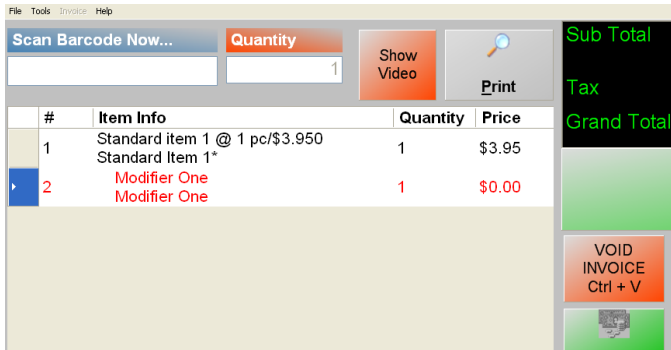

- In **Cash Register Express** (retail) the **Show Video** button will be located at the top of the screen (next to the **Print** button).

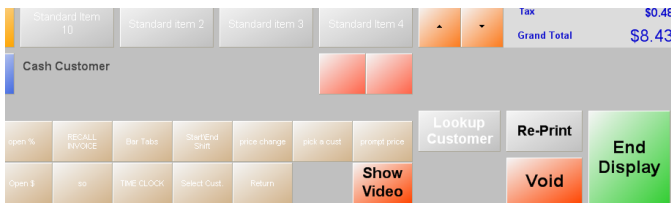

- In **Restaurant Pro Express** (restaurant) the **Show Video** button will be located at the bottom of the screen (in place of one of the hotbuttons).

Note: The **Show Video** button will **ONLY** be visible when the Invoice status is **Complete** or **Void**.

If the invoice status is **On Hold \ Layaway** the **Show Video** button will **NOT** be visible.